



---

# FRESH BREW PLUS THERMAL CARAFE COFFEE MAKER

---

## OPERATING INSTRUCTIONS

# EC-YSC100

Always follow basic safety precautions when using electrical appliances.  
Read all instructions carefully.  
Please keep these Operating Instructions at hand for easy reference.

### INDEX

IMPORTANT SAFEGUARDS .....	2
PARTS NAMES .....	5
HOW TO SET THE CLOCK .....	6
SOUND SIGNALS AND HOW TO CHANGE THEM ....	6
HOW TO USE .....	7
HOW TO SET THE TIMER .....	10
HOW TO ATTACH AND REMOVE EACH PART ...	11
CLEANING AND MAINTENANCE .....	12
TROUBLESHOOTING GUIDE .....	15
REPLACEMENT PARTS .....	15
SPECIFICATIONS .....	16

# IMPORTANT SAFEGUARDS

Be sure to follow the instructions.

To reduce the risk of fire, electric shock, and / or injury to persons, when using electrical appliances, basic safety precautions should always be followed, including the following:

1. Read all instructions.
2. Do not touch hot surfaces. Use handles or knobs. Do not close or clog the steam vent opening under any circumstances.
3. To protect against fire, electric shock and other injury to persons, do not immerse cord, plugs or the appliance in water or other liquids.
4. Close supervision is necessary when any appliance is used by or near children.
5. Unplug from outlet when not in use and before cleaning. Allow to cool before adding or removing parts other than the Carafe, and before cleaning the appliance.
6. Do not operate any appliance with a damaged cord or plug, or after the appliance malfunctions or has been damaged in any manner. Return appliance to the nearest authorized service facility for examination, repair or adjustment.
7. The use of accessory attachments not recommended by the appliance manufacturer may result in fire, electric shock or other injury to persons.
8. Do not use outdoors.
9. Keep the power cord away from hot surfaces and do not let the cord hang over the edge of tables or counters.
10. Do not place on or near a hot gas or electric burner, or in a heated oven.
11. To disconnect, turn the power off by pressing the CANCEL button, then remove plug from wall outlet.
12. Do not use appliance for other than intended use.
13. To protect against electrical hazards, unplug the cord at all times before cleaning.
14. Scalding may occur if the Swing Basket or Filter Basket is removed during the brewing cycles.



NOTE: This appliance has a polarized plug (one blade is wider than the other). To reduce the risk of electric shock, this plug is intended to fit into a polarized outlet only one way. If the plug does not fit fully into the outlet, reverse the plug. If it still does not fit, contact a qualified electrician. Do not attempt to modify the plug in any way.

## SAVE THESE INSTRUCTIONS

### THIS APPLIANCE IS FOR HOUSEHOLD USE ONLY.







- A. A short power-supply cord is provided to reduce risks resulting from becoming entangled in or tripping over a longer cord.
- B. Extension cords may be used if care is exercised in their use.
- C. If an extension cord is used, (1) the marked electrical rating of the extension cord should be at least as great as the electrical rating of the appliance, (2) if the appliance is of the grounded type, the extension cord should be a grounding-type 3-wire cord, and (3) the longer cord should be arranged so that it will not drape over the counter top or table top where it can be pulled on by children or tripped over.

	<b>WARNING</b> RISK OF FIRE OR ELECTRIC SHOCK DO NOT OPEN	
WARNING: TO REDUCE THE RISK OF FIRE OR ELECTRIC SHOCK, DO NOT REMOVE COVER (OR BOTTOM) NO USER-SERVICEABLE PARTS INSIDE REPAIRS SHOULD BE DONE BY AUTHORIZED SERVICE PERSONNEL ONLY		

	The lightning flash with arrowhead symbol, within an equilateral triangle, is intended to alert the user to the presence of uninsulated "dangerous voltage" within the product's enclosure that may be of sufficient magnitude to constitute a risk of fire or electric shock to persons.
	The exclamation point within an equilateral triangle is intended to alert the user to the presence of important operating and maintenance (servicing) instructions in this literature.

These WARNINGS and CAUTIONS are intended to prevent property damage or personal injury to you and others.

## ⚠️ WARNINGS



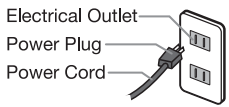

<p> <b>Do not modify the product. Only a repair technician may disassemble or repair this unit.</b> Attempting to do so may cause fire, electric shock or injury. Make any repair inquiries to Zojirushi Customer Service.</p> <p> <b>Do not immerse the product in water or splash it with water.</b> Doing so may cause short circuit or electric shock.</p> <p> <b>Do not plug or unplug the Power Plug if your hands are wet.</b> Doing so may cause electric shock or injury.</p> <p> <b>Do not touch the Steam Vent or bring your hands or face near the Steam Vent.</b> Doing so may cause burns or scalding. Take special precautions with children and infants.</p> <p> <b>Do not allow children to use the product unsupervised. Keep it out of the reach of infants.</b> Children are at risk of burns, electric shock or injury.</p> <p><b>Do not use a power source other than 120V AC.</b> Use of any other power supply voltage may cause fire or electric shock.</p> <p><b>Do not use this product without the Stainless Carafe.</b> Doing so may cause scalding.</p> <p><b>Do not use the product if the Power Plug or Power Cord is damaged or if the Power Plug is loosely inserted into the electrical outlet.</b> Doing so may cause electric shock, short circuit or fire.</p> <p><b>Do not damage the Power Cord. Do not bend, pull, twist, fold, or attempt to modify the Power Cord. Do not place it on or near high temperature surfaces or appliances, under heavy items or between objects.</b> A damaged Power Cord can cause fire or electric shock.</p>	<p> <b>Insert the Power Plug completely and securely into the electrical outlet.</b> A loosely inserted Power Plug may cause electric shock, short circuit, smoke or fire.</p> <p><b>Use only an electrical outlet rated at 15 amperes minimum, and do not plug other devices into the same outlet.</b> Plugging other devices into the same outlet may cause the electrical outlet to overheat, resulting in fire.</p> <p><b>If the blades or surface of the Power Plug become soiled, wipe them clean.</b> A dirty Power Plug may cause fire.</p> <p><b>Stop using immediately if you notice any of the following symptoms indicating a malfunction or breakdown.</b> Continued use of the product may cause smoke, fire, electric shock or injury.</p> <ul style="list-style-type: none"> <li>• The Power Plug or Power Cord has become very hot.</li> <li>• The Power Cord is deeply damaged or deformed.</li> <li>• There is a burning smell.</li> <li>• Some part of the product is cracked, unstable or loose.</li> <li>• The electricity turns on and off when the Power Cord is touched or moved.</li> <li>• The product does not operate even though it is turned on.</li> <li>• Water leaks from the Main Body.</li> </ul> <p>If any of the above occurs, unplug the product immediately and return to Zojirushi Customer Service for check-ups and/or repairs.</p> <p><b>This appliance is not intended for use by persons (including children) with reduced physical, sensory or mental capabilities, or lack of experience and knowledge, unless they have been given supervision or instruction concerning use of the appliance by a person responsible for their safety. Children should be supervised to ensure that they do not play with the appliance.</b></p>
--	---



● The illustrations used in these Operating Instructions may vary from the actual product you have purchased.

# IMPORTANT SAFEGUARDS (cont.)

## CAUTIONS

 <p><b>Do not touch hot surfaces during or for a short period of time after use.</b> Touching hot surfaces may cause burns or injury.</p>	 <p><b>Unplug the Power Plug from the outlet when the product is not in use.</b> Leaving the Power Plug in an outlet may cause the insulation to become damaged, resulting in electric shock, short circuit or fire.</p>
 <p><b>Do not place or use the product on unstable surfaces or on surfaces that are vulnerable to heat.</b> Doing so may cause fire.</p>	 <p><b>Please allow the product to cool down before cleaning.</b> Touching hot surfaces may cause burns.</p>
<p><b>Do not remove the Stainless Carafe while brewing.</b> Doing so may cause scalding.</p>	<p><b>Always unplug the product by holding the Power Plug, not by pulling the Power Cord.</b> Pulling the Power Cord to unplug the product may cause electric shock, short circuit or fire.</p>
<p><b>Do not use the product near walls or furniture.</b> Steam or heat may damage, discolor or deform walls or furniture.</p>	<p><b>If the Power Cord is damaged, it must be replaced by the manufacturer, its service agent or similarly qualified persons to avoid hazards.</b></p>
<p><b>Do not move the product when the Stainless Carafe is in place.</b> Doing so may cause scalding or other injury.</p>	

## IMPORTANT

<p>■ <b>Do not use a coffee carafe other than the Stainless Carafe specifically designed for use with this product.</b> Using any other coffee carafe may cause scalding as the coffee may overflow from the carafe.</p>	<p>■ <b>Do not use the Stainless Carafe for purposes other than filling it with coffee. In particular, do not under any circumstances fill the Carafe with the following liquids or foods.</b></p> <ul style="list-style-type: none"> <li>● <b>Dry ice and carbonated drinks:</b> Contents may spill out or the pressure may cause the Carafe Lid Set to burst, causing injuries.</li> <li>● <b>Liquids high in sodium such as soup and Kobo-cha:</b> Although the liner is made of 18/8 stainless steel, salt may cause rust resulting in loss of thermal insulation.</li> <li>● <b>Dairy products and fruit juice:</b> If left inside for a long period of time, contents may spoil and produce gas that may cause the Carafe Lid Set to burst, causing injuries.</li> <li>● <b>Fruit pulp and tea leaves:</b> May become caught in the Carafe Lid Set and cause contents to spoil.</li> </ul>
<p>■ <b>Do not heat the Stainless Carafe in a microwave oven or place it on top of direct flames (such as a gas stove top), or electric or induction heating (IH) stove tops.</b> Doing so may cause smoke or fire. The Handle of the Carafe may deform or sparks may be emitted from the metal parts.</p>	<p>■ <b>Do not immerse the Stainless Carafe in water.</b> Water can collect in gaps within the Carafe and cause rusting or deformation.</p>
<p>■ <b>Do not fill the Water Tank with other than water, such as milk, alcohol, coffee, or hot water.</b> Doing so may cause malfunction.</p>	<p>■ <b>Unplug the Power Plug from the outlet soon after use.</b> Leaving the Power Plug continuously inserted in an outlet for long periods may cause a malfunction, resulting in overheating or smoke.</p>
<p>■ <b>Do not use the product where its steam may come into contact with other electrical appliances.</b> The steam may cause fire, malfunction, discoloration or deformation to other electrical appliances.</p>	<p>■ <b>Do not peel off the label affixed to the bottom of the Stainless Carafe.</b> Doing so may cause damage, such as rusting or pinholes.</p> 
<p>■ <b>When brewing coffee consecutively, wait at least 5 minutes after the START light turns off.</b> Be careful when adding water or moving the product while it is still hot as steam or hot water may come out from the Shower Head and may cause scalding.</p>	<p>■ <b>This appliance is intended for household use and similar applications listed below:</b></p> <ul style="list-style-type: none"> <li>● Staff (employee) kitchen areas in shops, offices and other working environments.</li> <li>※ This appliance is not intended for use by many unspecified people for a long period of time.</li> </ul> <p><b>This appliance must not be used in the following areas:</b></p> <ul style="list-style-type: none"> <li>● Farm houses.</li> <li>● By clients in hotels, motels and other residential type environments.</li> <li>● Bed and breakfast type environments.</li> </ul>
<p>■ <b>Do not use or place the product on wet surfaces.</b> Doing so may cause electric shock.</p>	
<p>■ <b>Do not drop the Stainless Carafe or hit it against a hard surface or object.</b> Such an impact may damage the plastic parts or dent the surface of the Carafe and degrade its performance in keeping the coffee hot.</p>	
<p>■ <b>Do not operate the product without filling the Water Tank with water.</b> Doing so may cause malfunction.</p>	
<p>■ <b>Do not carry the Stainless Carafe in a tilted position or while pressing down on the Carafe Button.</b> Doing so may cause the contents of the Carafe to spill and cause burns.</p>	



# PARTS NAMES

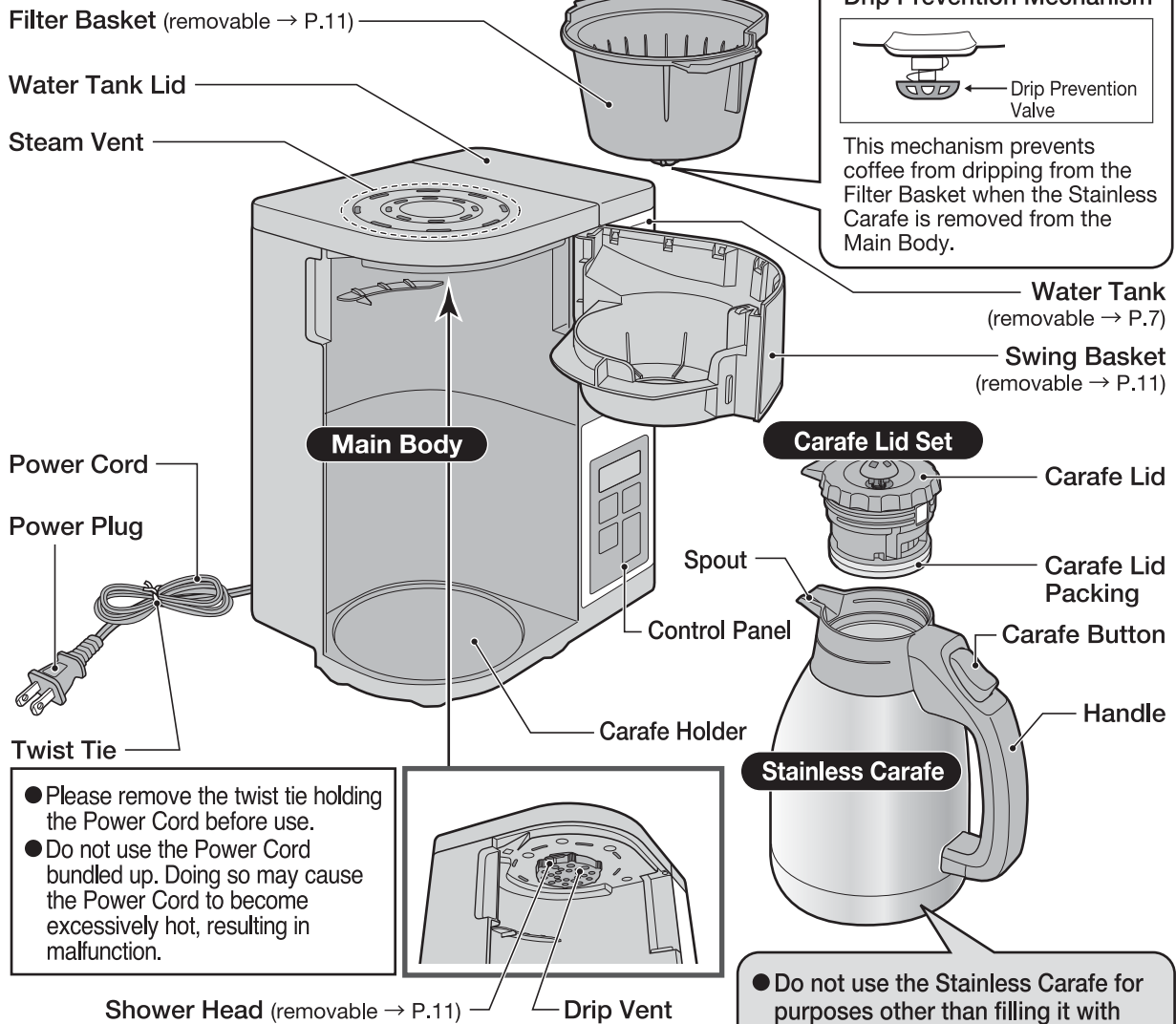

- Please remove the twist tie holding the Power Cord before use.
- Do not use the Power Cord bundled up. Doing so may cause the Power Cord to become excessively hot, resulting in malfunction.

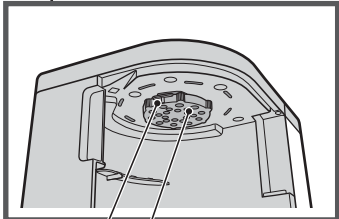

- Do not use the Stainless Carafe for purposes other than filling it with coffee.
- The Carafe Lid is not hermetically sealed. If the Carafe tips over, hot liquid may spill out and cause burns.

### Control Panel

The illustration is for reference only. Actual display will not show all functions simultaneously during use.

**Display**

AM PM 10:00

**CANCEL button**

**TIMER button**

**CLEAN button**

**START light**

**START button**

**TIMER light**

**TIME SETTING button**

**CLEAN light**

### Accessories:

- **Measuring Spoon**  
(level off when measuring)

For 1 cup (About 5.1g)

For 2 cups (About 10.2g)

- **Basket Coffee Filter (4 pcs.)**  
Purchase standard size Basket Coffee Filters (8-12 cups) when you have used up all of the supplied filters.

# HOW TO SET THE CLOCK

e.g.: If the current time is PM1:01 but displays PM12:58.

## 1 Insert the Power Plug into an outlet.

The current time appears on the Display.

## 2 Press the TIME SETTING button (▲ ▼) to set the current time on the Display.

The time display will start to blink.

- ▲ button: Each press advances the time in 1-minute increments.
- ▼ button: Each press moves the clock in reverse by 1 minute.

- Press and hold either button to quickly adjust in 10-minute increments.

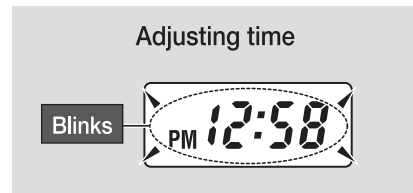

## 3 The time display will stop blinking after 3 seconds, indicating the Time Setting is completed.

If the time display still does not show the current time, repeat Step 2 to readjust the time.

- If the display shows a blinking "AM7:00" when the Power Plug is inserted, the built-in lithium battery is running out. You may continue using the product and readjust the time each time the Power Plug is plugged in. (To replace the battery → P. 15)

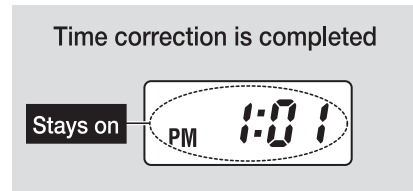

# SOUND SIGNALS AND HOW TO CHANGE THEM

This product is equipped with a Sound Signal function, which will inform you when brewing has completed. The product is designed to Beep by default. To change to Silent:

### To Change Setting:

- 1 Insert the Power Plug into an outlet.
- 2 Hold the **CANCEL** button for more than 3 seconds.
- 3 The setting is completed when the desired Sound Signal is heard.

- The tone that indicates button inputs will sound even when Silent is selected.
- The selected Sound Signal is stored and will remain even if the product is unplugged.

### When Changing the Sound Signal:

Each time the **CANCEL** button is held for more than 3 seconds, the Sound Signal will change.

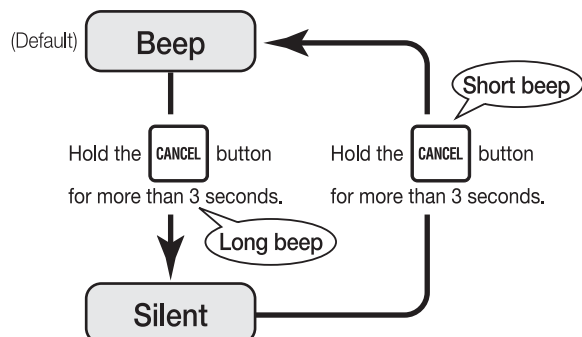

# HOW TO USE

● **Prior to initial use or when using the product after a long period of storage:**

Wash the Shower Head, the Stainless Carafe, and the Filter Basket and then operate the product once or twice using only water.

- This product is intended for household use only and not for commercial use.
- This product has been designed for brewing coffee only. **Do not use it for any other purpose.** Do not fill the Water Tank with other than cold water (such as milk, alcohol, coffee, or hot water), as doing so may cause malfunction.
- The first time you use the product you may notice the smell of plastic. This is normal and will gradually fade away.
- Do not carry the product by the Swing Basket or Water Tank.

## 1 Add ground coffee.

- ① Open the Swing Basket and place the Basket Coffee Filter into the Filter Basket.
- ② Measure ground coffee using the provided Measuring Spoon, place in the Basket Coffee Filter and level off the top.
- ③ Close the Swing Basket.

- Do not use fine grind coffee as it may clog the Basket Coffee Filter and the coffee may overflow from the Swing Basket.
- Do not brew less than 2 cups.
- When opening and closing the Swing Basket, make sure that the Main Body does not tip over.

Place your fingers here to open the Swing Basket.

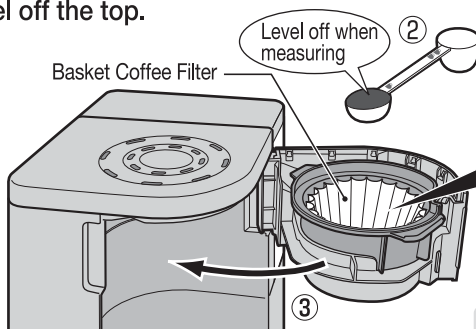
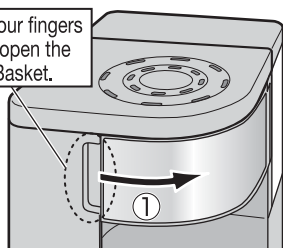

Add the ground coffee in the Basket Coffee Filter and level off the top.

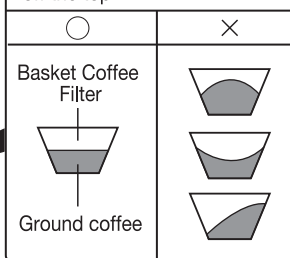

## ■ Brewing Guidelines

※When using the Measuring Spoon for 1 cup (☐).

Cups Brewed		2	3	4	5	6	7	8	9	10
Ground Coffee	In Measuring Spoon*	2	3	4	5	6	7	8	9	10
	Approx. g	10.2	15.3	20.4	25.5	30.6	35.7	40.8	45.9	51
	Approx. oz.	0.36	0.54	0.72	0.9	1.08	1.26	1.44	1.62	1.8

## 2 Fill the Water Tank with water.

- ① Remove the Water Tank from the Main Body.

- Hold down the Main Body and carefully remove the Water Tank. If you are not careful, the Main Body may lift with the Tank and fall. (Do not touch the Steam Vent.)

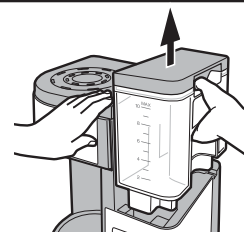

- ② Use the Scale on the Water Tank and fill to the line corresponding to the number of cups of coffee being brewed, and then close the Water Tank Lid.

- Do not add water above the MAX line on the Water Tank. Also do not refill the Water Tank while coffee is brewing. Doing so may cause the coffee to overflow from the Stainless Carafe.
- Do not fill the Water Tank with hot water as doing so may cause malfunction.

The Scale on the Water Tank

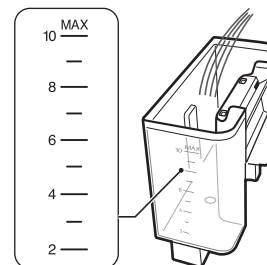

### Precautions When Using Hard Water:

- Do not use water with 400ppm or more total dissolved solids. Scale (formed from minerals contained in water) may build up inside the pipes of the product and hinder the brewing performance. For example, brewing may take longer or water may not drip properly.
- We recommend using water with 200ppm or less total dissolved solids.
- If brewing takes longer than usual, please clean the product using citric acid. (→P.14)

# HOW TO USE (cont.)

## 3 Preheat the Stainless Carafe.

- ① To improve the heat-retention ability of the Stainless Carafe, fill with a small amount of hot water and preheat for about 1 minute.
- ② After preheating, discard the hot water.



## 4 Set the Water Tank and the Stainless Carafe in the Main Body.

- ① Be sure that the Water Tank is securely attached onto the Main Body with the bottom firmly seated.
- ② Make sure that the Stainless Carafe is empty. Close the Carafe Lid Set and place the Carafe in the Main Body.

- If the Stainless Carafe contains hot water or coffee when you begin brewing, coffee may overflow from the Carafe.
- When placing the Stainless Carafe, do not apply excessive force to the Drip Prevention Valve.

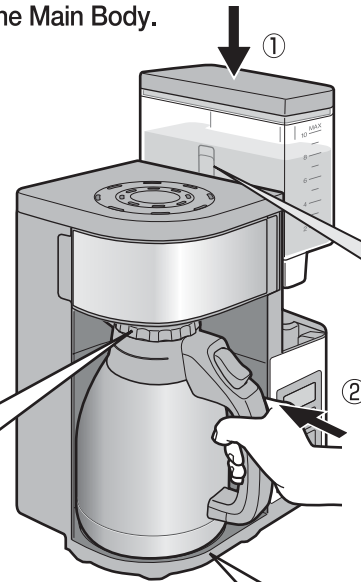
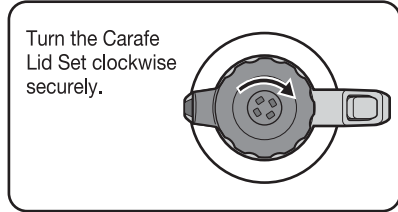

- The Stainless Carafe should fit in the Carafe Holder securely.

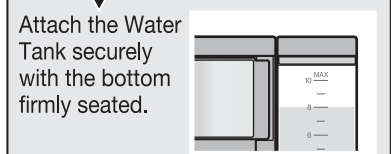
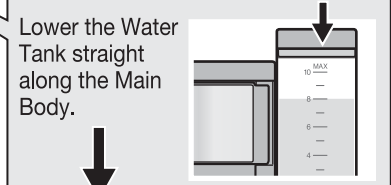
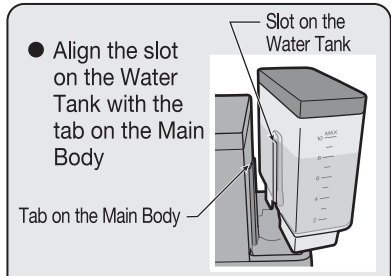

- Malfunction may occur if the Water Tank is not attached securely. Hot water also may not dispense during brewing.

## 5 Insert the Power Plug into the outlet and press the button.

The START light will turn on and brewing will begin. The Display will look like the illustration on the right during brewing.

- Do not use or place the product on wet surfaces. Doing so may cause electric shock.

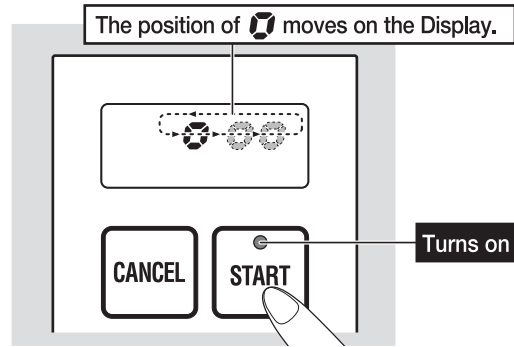

■ **Estimated Time Until Completion:** [based on water and room temperature of 68°F (20°C)]

Cups	2 Cups	3 Cups	4 Cups	5 Cups	6 Cups	7 Cups	8 Cups	9 Cups	10 Cups
Estimated Time	5 min.	5.5 min.	6.5 min.	7 min.	8 min.	8.5 min.	9.5 min.	10.5 min.	11 min.

- The estimated time until completion may vary depending on the amount of water, water temperature and the amount of ground coffee.

## 6 When brewing completes, pour coffee.

- ① When brewing completes, the START light will turn off and the Display will look like the illustration on the right.
- ② After brewing completes, press the CANCEL button and unplug the Power Plug from the outlet.
- ③ Remove the Stainless Carafe and press and hold the Carafe Button to pour coffee.
  - Some coffee will be left in the Filter Basket immediately after the START light turns off. Wait until coffee is no longer dripping from the Filter Basket and then remove the Stainless Carafe.
  - When tilting the Stainless Carafe, a small amount of coffee may drip from the Spout or from the holes of the Carafe Lid.
- ④ When done pouring, keep pressing the Carafe Button and place the Stainless Carafe on a flat surface.
- ⑤ Let go of the Carafe Button.

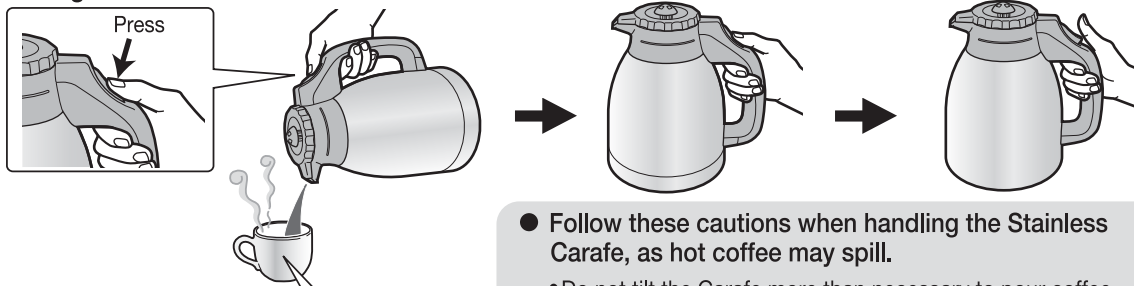
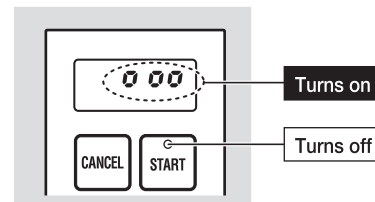

For very hot coffee, preheat cups with hot water or use other methods when serving.

- Follow these cautions when handling the Stainless Carafe, as hot coffee may spill.
  - Do not tilt the Carafe more than necessary to pour coffee.
  - Do not tilt or hold the Carafe under your arm when carrying.
  - Do not tip over the Carafe.

## Automatic Shut-Off Function

Beeps will sound, the START light and TIMER light turn on and “HH” will appear on the Display.

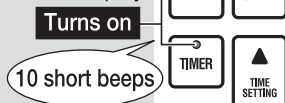

The Automatic Shut-Off function activates to shut off power to the heater in order to prevent damage from overheating. The Display will show “HH” to alert you that the Automatic Shut-Off has been activated. The following conditions may cause activation:

- When the START button is pressed without filling the Water Tank with water, or the water level is lower.
- When brewing coffee consecutively without allowing the Main Body to cool.

**Remedy** Press the CANCEL button. Allow the product to cool. Fill the Water Tank with water and press the START button.

## How to Cancel Brewing in the Middle of the Process

- ① Press the CANCEL button.
- ② Make sure coffee is no longer dripping from the Filter Basket, then remove the Stainless Carafe and the Filter Basket.
- ③ After the Main Body has cooled down, discard the remaining water in the Water Tank.
  - Water may drip when removing the Water Tank.
  - Press the CANCEL button only to cancel during brewing. If the CANCEL button is pressed accidentally, press the START button to continue brewing.

## When Brewing Coffee Consecutively

- To brew your next pot of coffee, be sure to wait at least 5 minutes after the START light turns off, and then follow “HOW TO USE” from step 1.
- Do not add water or move the product while it is still hot.

## When Keeping Coffee Warm

- Although the Stainless Carafe can keep coffee warm using vacuum insulation, the coffee temperature will gradually drop.
- Firmly close the Carafe Lid Set.
- If the Stainless Carafe contains small amounts of coffee or the room temperature is low, the Carafe absorbs the heat of the coffee and the coffee temperature will drop faster.
- Be sure to enjoy the coffee immediately. The aroma and flavor of the coffee will deteriorate if left in the Stainless Carafe for a long time.

# HOW TO SET THE TIMER

The Timer allows you to delay the time to begin brewing.

- The Timer can be set from the current time until 24 hours in advance.
- Do not set the timer too far in advance if the room temperature is high, such as during summer. Doing so may cause water quality to deteriorate or the aroma and flavor of the coffee to be lost.
- Press the TIME SETTING button (▲▼) to check the current time during Timer setting.

e.g.: To set the Timer for AM7:00 when the current time is PM11:00.

## 1 Prepare the product for brewing and press the button.

The current time on the Display and the TIMER light will begin to blink.

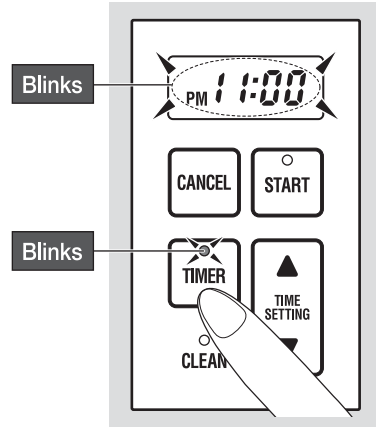

## 2 Press the TIME SETTING button (▲▼) to select the time you want to begin brewing.

- ▲ button: Advances the clock in 10-minute increments.
- ▼ button: Moves the clock in reverse in 10-minute increments.

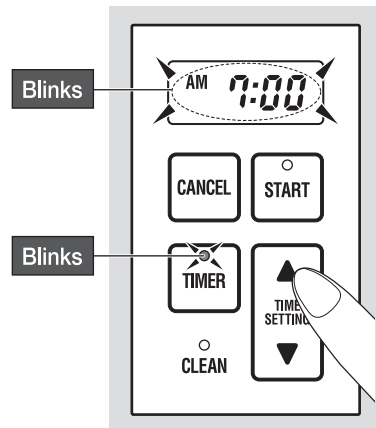

## 3 Press the button.

When the time on the Display and the TIMER light stop blinking and stay on, the Timer has been set properly. The Display will indicate the time at which brewing will begin.

- The START button must be pressed for the product to begin brewing automatically.

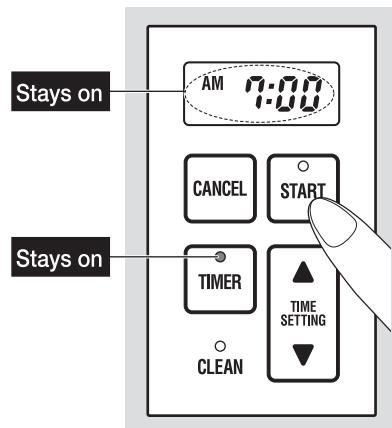

### To Cancel the Timer Setting

- Press the CANCEL button. (The TIMER light will turn off and the Display will show the current time.)



# HOW TO ATTACH AND REMOVE EACH PART

## Filter Basket

### How to Remove

- ① Open the Swing Basket.
- ② Remove the Filter Basket.

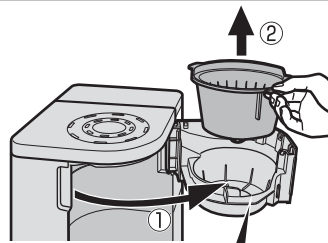

### How to Attach

Align the slot on the Swing Basket with the tabs on the Filter Basket to attach.

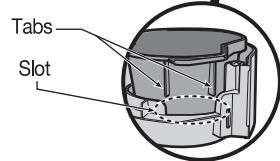

## Carafe Lid Packing

After removing the Carafe Lid Packing for cleaning or other maintenance work, reattach it carefully as shown in the illustration below.

The flat surface should be on top

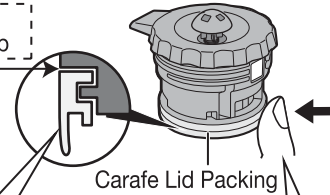

Avoid putting the Packing on upside-down (doing so may cause the beverage to leak out).

Press the Carafe Lid Packing toward the center from the outside using your fingers.

## Swing Basket

- Remove the Stainless Carafe and the Filter Basket before performing the following.

### How to Remove

- ① Open the Swing Basket fully and lift to undo the bottom tab.

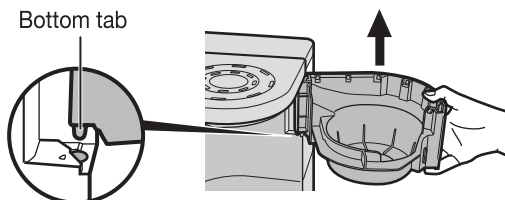

- ② Slide the Swing Basket in the direction of the arrow and remove the Basket in a downward direction.

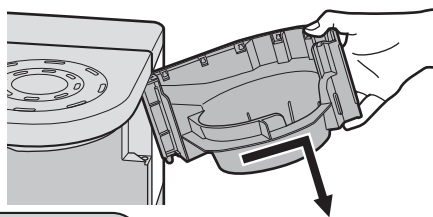

### How to Attach

Insert the upper tab of the Swing Basket into the upper slot of the Main Body and then align the lower tab with the lower slot to insert.

Attach the upper tab of the Swing Basket to the position of the "▼" on the top of Main Body.

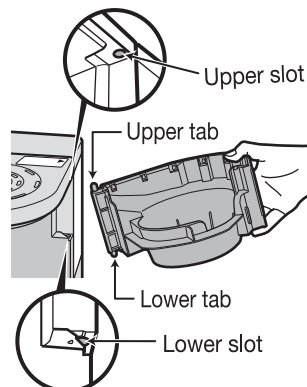
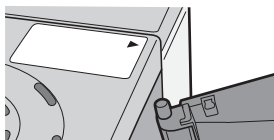

## Shower Head

### How to Remove

Turn the Shower Head in the direction of the arrow to remove.

- Remove the Shower Head after the Main Body has cooled down completely. (Not doing so may cause burns.)
- Remove the Shower Head carefully as water may leak from it.

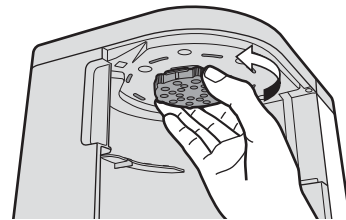

- This illustration shows the view from below.

### How to Attach

Align the tab on the Shower Head with the slot on the Main Body and turn the Shower Head in the direction of the arrow.

- Make sure to set the Shower Head securely.

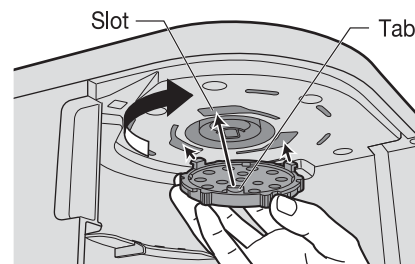

# CLEANING AND MAINTENANCE

Always unplug the product from the electrical outlet and allow it to cool completely before cleaning.

- Do not splash the Main Body, Power Cord and Power Plug with water or immerse them in water. Doing so may cause electric shock or malfunction.
- Do not use hot water to wash the product or parts as they may deform or break.
- Do not use the following:
  - Detergents other than mild kitchen detergent, such as thinner, benzene and bleach. Doing so may cause discoloration, cracks, degradation or corrosion.
  - Polishing powder, nylon brushes, scrub brushes, anything made with metal, eraser pads, hard nylon sponges and abrasive cleaners. Doing so may cause corrosion.
- When using chemically treated cloths, do not rub too hard or leave them on the product for a long time as the surface of the product may become damaged from chemical reactions.
- Do not use a dishwasher or a dish-dryer. Doing so may cause deformation.

### Main Body

- ① Wipe the Main Body clean with a soft cloth immersed in diluted mild kitchen detergent and wrung well.
- ② Wipe with a well-wrung soft damp cloth.
- ③ Wipe dry with a soft dry cloth.

### Water Tank, Water Tank Lid, and Swing Basket

- ① Wash with a sponge or soft material with diluted mild kitchen detergent.
- ② Rinse with water.
- ③ Wipe dry with a soft dry cloth.

- Be sure to fully drain water from the Swing Basket. Otherwise, this water may drip into your coffee during brewing.

### Shower Head

Rinse the Shower Head under running water and dry well.

- Do not disassemble the Shower Head. If the Shower Head becomes disassembled, reassemble it correctly as shown below.

Align the slots (3 locations) on the Upper Shower Head with the tabs (3 locations) on the Lower Shower Head to attach.

Upper Shower Head  
Lower Shower Head  
Slots  
Tabs

### Filter Basket

- ① Wash the Filter Basket clean with a sponge or soft material with diluted mild kitchen detergent.
- ② Rinse with water.
- ③ Pour water in the Filter Basket, press the Drip Prevention Valve two or three times and wash.
- ④ Wipe dry with a soft dry cloth.

- If coffee grounds clog the Drip Prevention Valve, it may not seal properly and coffee may overflow. Be sure to wash it after each use.
- Be sure to fully drain water from the Filter Basket. Otherwise, this water may drip into your coffee during brewing.
- Handle the Drip Prevention Valve carefully. Pulling on it may cause it to come off.

Drip Prevention Valve

- Do not disassemble the Drip Prevention Valve. If it comes off, reattach correctly as shown below.

- ① Place the spring on the Filter Basket.
- ② Insert the Drip Prevention Valve through the spring and into the opening of the Filter Basket.
- ③ Hold the Drip Prevention Valve in and attach the Rubber Gasket to the groove from the inside.

Drip Prevention Valve  
Spring  
Opening  
Filter Basket  
Rubber Gasket  
Groove  
Attach the Rubber Gasket here.

Be sure that the Rubber Gasket is attached securely. Water may leak if it is attached twisted or is loose.

○	Attached correctly.	
×	Water leaks from gaps	Distorted
		Loose

### Power Cord and Power Plug

Wipe with a soft dry cloth.

## Stainless Carafe

### Stainless Carafe (Exterior)

- ① Wash the Carafe with a sponge or soft material with diluted mild kitchen detergent.
- ② Rinse with water and shake several times.
- ③ Wipe dry with a soft dry cloth.

- Do not immerse the Stainless Carafe in water. Water can collect in gaps within the Carafe and cause rusting or deformation.

### Stainless Carafe (Interior)

- ① Wash the inside of the Carafe with a sponge brush or similar tool (with a handle) with diluted mild kitchen detergent.
  - When you press the Carafe Button, a pin will pop out. Make sure to wash this pin as well when you wash the inside of the Carafe.
- ② Rinse with water and dry.

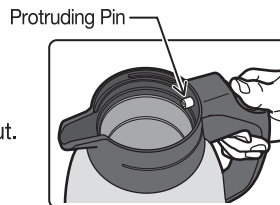

- Cleaning the Carafe on a regular basis will prevent odors and maintain it in spotless condition.

- To remove stains from the Stainless Carafe, a food safe coffee pot cleaner is recommended for cleaning. (When cleaning the Stainless Carafe using a food safe coffee pot cleaner, remove the Carafe Lid Set.)

## Carafe Lid Set

- ① Remove the Carafe Lid Packing.

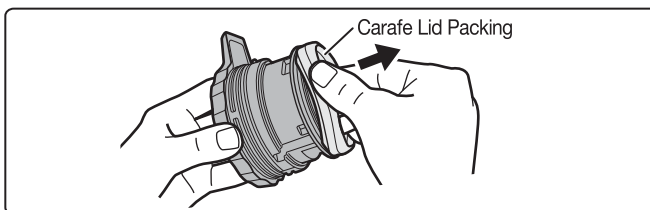

- ② Wash the Carafe Lid and Carafe Lid Packing with a sponge or soft material with diluted mild kitchen detergent.
- ③ Rinse with water.
  - Clean the part where coffee passes through within the Carafe Lid with water after each use to prevent clogging.

To clean the part where coffee passes through within the Carafe Lid, press and hold the Carafe Lid Valve or Slide Lever and rinse with running water as shown in the illustration below.

Press and hold down the Carafe Lid Valve.

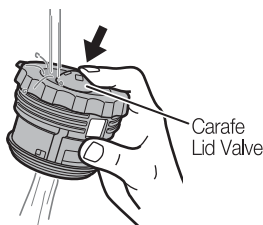

Press and hold the Slide Lever.

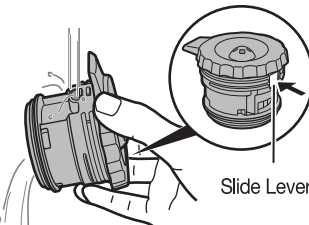

- ④ Shake the Carafe Lid several times while pressing and holding the Carafe Lid Valve or Slide Lever. (Otherwise, the remaining water may drip.)
- ⑤ Wipe dry with a dry cloth.
- ⑥ Reattach the Carafe Lid Packing in its original position.

- If the Carafe Lid Packing is damaged, discolored or turns white, replace with a new one.

- Do not detach or disassemble any part of the Carafe Lid Set other than the Carafe Lid Packing. If parts of the Carafe Lid Set come off accidentally, reattach them correctly as shown below.

- ① Insert the Carafe Lid Valve into the spring and then insert into the opening of the Carafe Lid.

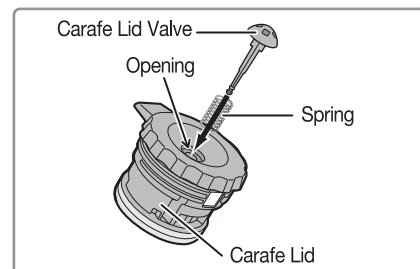

- ② Attach the Brew Valve Gasket to the Carafe Lid Valve.

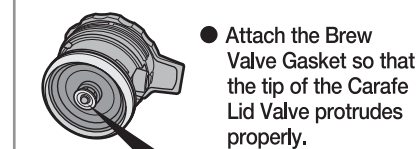
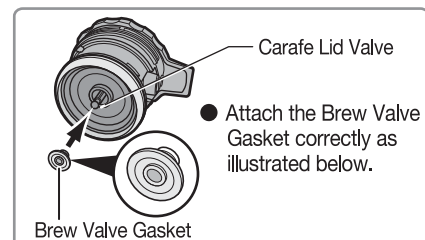

✗	○
The tip does not protrude properly.	The tip protrudes properly.

# CLEANING AND MAINTENANCE (cont.)

If the CLEAN light turns on or hot water does not dispense smoothly, perform citric acid cleaning.



- The CLEAN light will turn off if citric acid cleaning is performed or the TIMER button is held for more than 3 seconds when the current time on the Display.

Minerals contained in water may build up inside the pipes and other parts with use. These minerals are called “scale”.

**If scale accumulates, water may not drip smoothly, the amount of coffee brewed may be reduced, or hot water may leak from gaps in the Main Body.**

- The amount of scale build-up varies depending on the type and quality of water. More scale may build up if living in areas with hard water or when using mineral-rich water.
- Perform citric acid cleaning about every 4 weeks of usage.

Use the following procedure to remove scale.

## How to Perform Citric Acid Cleaning

- ① Put 1 package of the Citric Acid Cleaner CD-K03E-JU in a cup and add warm water to dissolve. Pour it into the Water Tank and fill with water to level 10 (MAX) on the Water Tank.
- ② Stir the citric acid solution well.
- ③ Set the Water Tank, Stainless Carafe (with the Carafe Lid Set attached), Filter Basket, and Swing Basket to the Main Body.
- ④ Hold the START button for more than 3 seconds to initiate the citric acid cleaning process.
  - To stop the citric acid cleaning process before it finishes, press the CANCEL button.
  - If cleaning was cancelled before it finished, restart the cleaning process from step ①.

- In order to prevent gas bubbles and bubbling-over, the Citric Acid Cleaner for Electric Water Boilers (CD-K03E-JU) is recommended for cleaning. (Available separately) →P.15  
Citric acid (100%) is used as a food additive and is harmless from a food sanitation standpoint, but do not consume it.

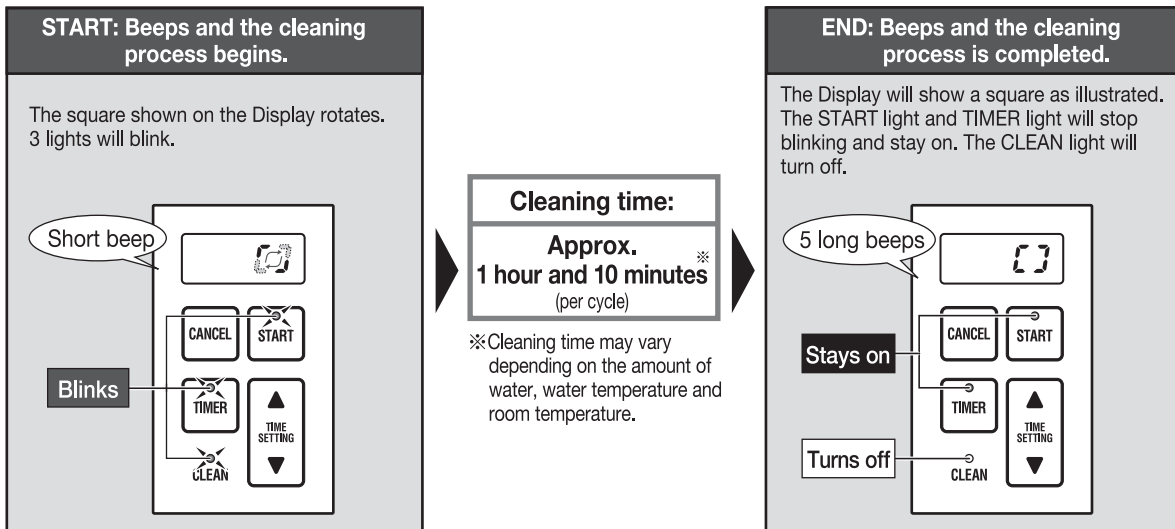

- ⑤ Press the CANCEL button.
- ⑥ When brewing completes, pour the citric acid solution from the Carafe to another container to cool, then remove any scale (white crystals, etc.) floating in the solution.
- ⑦ Pour citric acid solution from step ⑥ back into the Water Tank and repeat steps ④ to ⑥ until there are no more scale.
- ⑧ After the Main Body has cooled down completely, discard the citric acid solution in the Stainless Carafe and the Water Tank. Rinse and repeat the brewing process using only water a few times in order to remove the citric acid odor.
- ⑨ Press the CANCEL button and unplug the Power Plug from the outlet.
  - If hot water does not dispense smoothly, perform citric acid cleaning again.

# TROUBLESHOOTING GUIDE

Please check the following before calling for service.

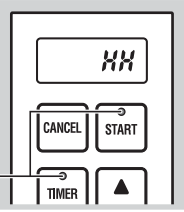
Condition	Cause	Remedy	
The product does not operate even when the START button is pressed.	Is the Power Plug inserted correctly?	Insert the Power Plug into the outlet.	
Hot water does not dispense. Hot water does not dispense smoothly.	Is the Water Tank filled with water?	Pour water into the Water Tank.	
	Is the Water Tank set correctly?	Set the Water Tank correctly.	
The coffee is not hot (the Carafe is not retaining heat properly).	Scale (minerals contained in water) may have accumulated inside the pipes of the product, preventing hot water from dispensing smoothly. Perform citric acid cleaning. (→P.14)		
	Has the coffee been left in the Stainless Carafe for a long time?	The coffee temperature will gradually drop as time passes.	
When the Carafe Button is pressed, it makes a sound. The Carafe Button does not go down smoothly.	When the Stainless Carafe contains small amounts of coffee or the room temperature is low, the temperature of the coffee will drop.		
	Does the pin that pops out when you press the Carafe Button look clean?	Clean the inside of the Stainless Carafe (protruding pin). (→P.13)	
"AM7:00" is blinking on the Display when the Power Plug is inserted.	The built-in lithium battery is out. Readjust the clock to use the product in a normal manner. To replace the lithium battery, contact the store where you purchased the product or Zojirushi Customer Service. (There will be a charge for the service.)		
Beeps sounds, lights turn on and <b>HH</b> appears on the Display.		Is the Water Tank filled with water?	The Automatic Shut-Off function has been engaged. (→P.9) Press the CANCEL button and wait until the product cools down. Fill with water and press the START button.
		Is the Water Tank low on water?	
<b>E2</b> , <b>E3</b> , <b>E4</b> or <b>E5</b> is displayed.	Indicates malfunction. Please contact Zojirushi Customer Service.		
	Did you try to brew coffee consecutively without allowing the Main Body to cool?		

## REPLACEMENT PARTS

- Replacement parts may be available for an additional charge. Please replace damaged parts only with new parts.
- When replacing parts, please note the model number and part name beforehand. Then contact either the store where you purchased the product or Zojirushi Customer Service.

**Zojirushi Customer Service**  
1-800-733-6270    www.zojirushi.com

Parts Names	Parts Number
Stainless Carafe Set (Stainless Carafe and Carafe Lid Set)	SERECYSC-XB
Carafe Lid Set	BX155818A-01
Measuring Spoon	BX155054L-01
Citric Acid Cleaner for Electric Water Boilers (1 oz. / 30 g × 4 packets)	CD-K03E-JU

# SPECIFICATIONS

Model No.		EC-YSC100
Rating		AC 120V 60Hz
Electric Consumption		1200W
Capacity		Max. 51 oz. (1.5 L)
Coffee Brewing System		Automatic Drip
Length of the Power Cord		2' 11" (0.9 m)
External Dimensions	(approx. inches)	10 <sup>-5/8</sup> (W) × 8 (D) × 14 <sup>-7/8</sup> (H)
	(approx. cm)	27 (W) × 20 (D) × 37.5 (H)
Weight		Approx. 9 lbs. (4.0 kg)

- External dimensions are measured without the handle of the Stainless Carafe.
- In high altitudes or severely cold areas, the product may not perform as specified. Avoid using the product in such areas or in other extreme conditions.





[www.zojirushi.com](http://www.zojirushi.com)

**FOR CALIFORNIA USA ONLY**

This product contains a CR Coin Lithium Battery which contains Perchlorate Material - special handling may apply  
See [www.dtsc.ca.gov/hazardouswaste/perchlorate](http://www.dtsc.ca.gov/hazardouswaste/perchlorate)

EC-YSC ©®